

ROLL-UP GYM DIVIDER



A Roll-Up gym divider is a convenient and simple way to divide an area. The curtain hangs from overhead supporting steel structures. Easy to operate: just turn a key, and the curtain unrolls as needed or rolls up for storage.

The white polyester webbing belts that guide the roll-up action are flexible and cut straight and true to insure proper wrapping of the belt onto the drive pipe. These thin, yet very strong belts take up less space as they wind onto the drive pipe, putting less strain on the motor.

- All hardware is heavy-gauge stamping or welded construction
- Vinyl-coated polyester material is available in 18 oz. and 22 oz.
- Total hanging weight is, on average, ½ lb. per sq. ft.
- Seams run horizontally the full width of the curtain.
- The stacking dimension is approximately 2'.
- Needs minimum of 6" of clearance between vertical edges and fixed objects.

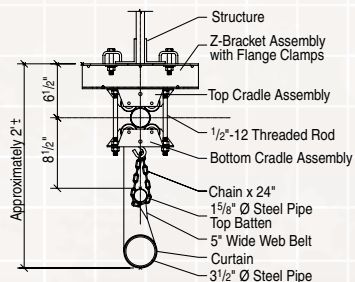

Dimensions, drawings and specifications available at:
www.draperinc.com/go/RollUpDivider.htm



University of Alabama, Student Recreation Center, Tuscaloosa, AL.
 Collegiate Citation Winner of Physical-Education Facilities/Recreation Centers, Education Interiors Showcase, American School & University magazine, August 2006. Architect: TMP Associates, Inc., Bloomfield Hills, MI. Photography © Curtis Photographics, Memphis, TN.



EcoVision™



For maximum safety, specify Draper's Curtain Lok on Roll-Up gym divider. See page 16 for details.

PATRIOT-MOTORIZED-FLAG

This unique gym equipment product makes a dramatic presentation of the United States flag in any gymnasium. "Old Glory" appears at the touch of a switch or wireless transmitter. Standard product includes a sewn, nylon flag. Options include state flags or school banners, provided by customer.

The Patriot can display a flag either vertically **500101** or horizontally **500102**. Flag measures 12' x 18' with both mountings. The vertical or banner flag is housed in a 14'10" case, and the horizontal flag is housed in a 20'10" case.



Patriot Motorized flag at Knightstown High School (IN).
 Architect: R.W. Clinton & Associates, Inc., Richmond, IN.
 Photography: Wayne Williams, Indianapolis, IN.